

# Florence – TAV

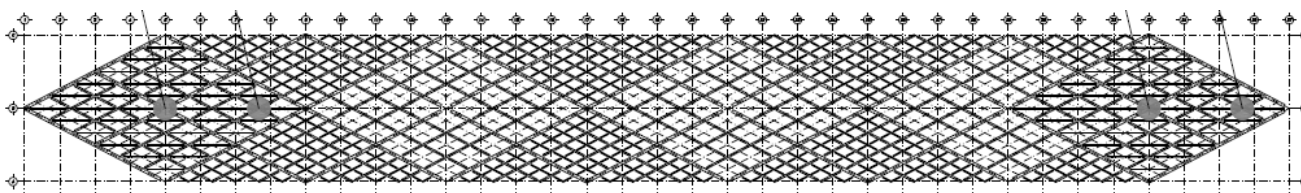
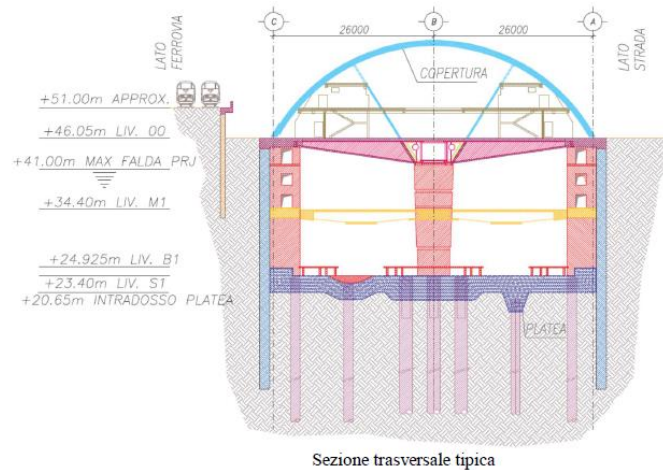
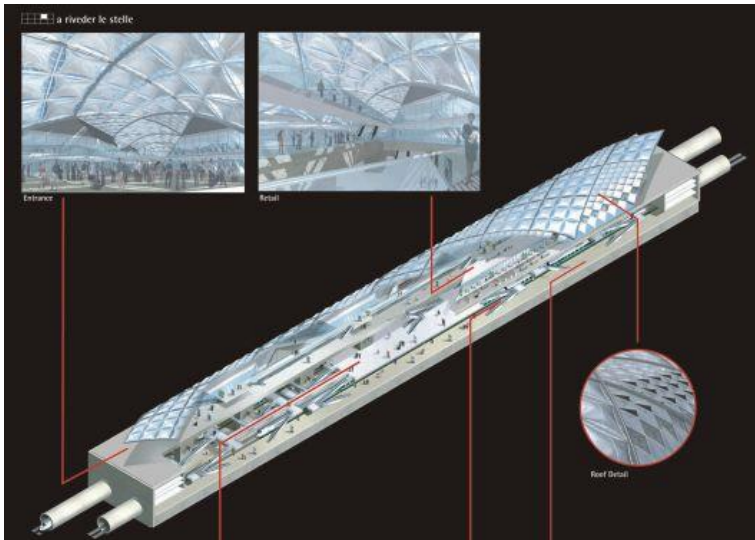
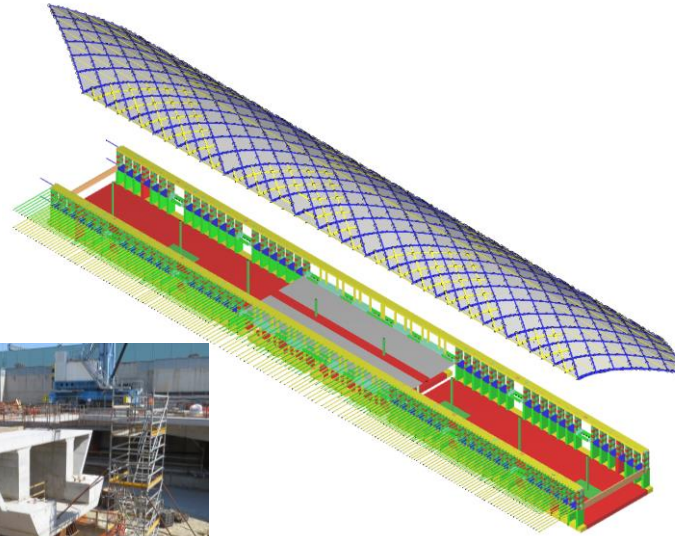

PIANTA COPERTURA

WORK DATA	
Location	Florence (ITA)
Year	2008 - 2011, 2015 - 2016, 2020 – under construction
Owner	RFI Rete Ferroviaria Italiana
Client	RFI Rete Ferroviaria Italiana
Structural Work cost	€ 250'000'000
Type	New construction
STRUCTURAL DESIGN	
Tender	-
Preliminary	-
Final	X
CHARACTERISTICS	
Plan Area	500m x 52m = 26'000 m <sup>2</sup>
Storey	2 underground + 2 above ground
Height	16 m above ground
Main Structure	Barrel Vault Roof with arches Diagrid (first, second e third order arches)
Slabs	Metal sheet slabs for commercial area levels
Foundation	Slab on piles, bulkheads and mezzain floor slab (top-down erection)